

The Design Behind FOUNDERS PARK

FIU Founders Park is designed to commemorate the founding figures of Florida International University.

The park is laid out as a winding path between three separate shade structures with soft corners. Forming a loop for visitors to follow, the park design provides views of the university, as well as areas to look back across the space of the park.

The shape forms both a singular rounded cohesive space for large gatherings, as well as three smaller bends in the perimeter wall for more intimate groups of various sizes. The campus hugs the edge of this park and seems to put gentle pressure on it as a form, feeling soft and malleable, influenced by the activities surrounding it.

Three overhead shade structures accommodate seating areas, which can be used as outdoor classrooms for current students and faculty. The path is constructed of custom pavers made of a hybrid, wood-based concrete material developed at our university. The names of the university's founders will be molded into the pavers, which constitute the path that users will follow as they walk through the park. These names of the founders will continue to grow as the university evolves over time.

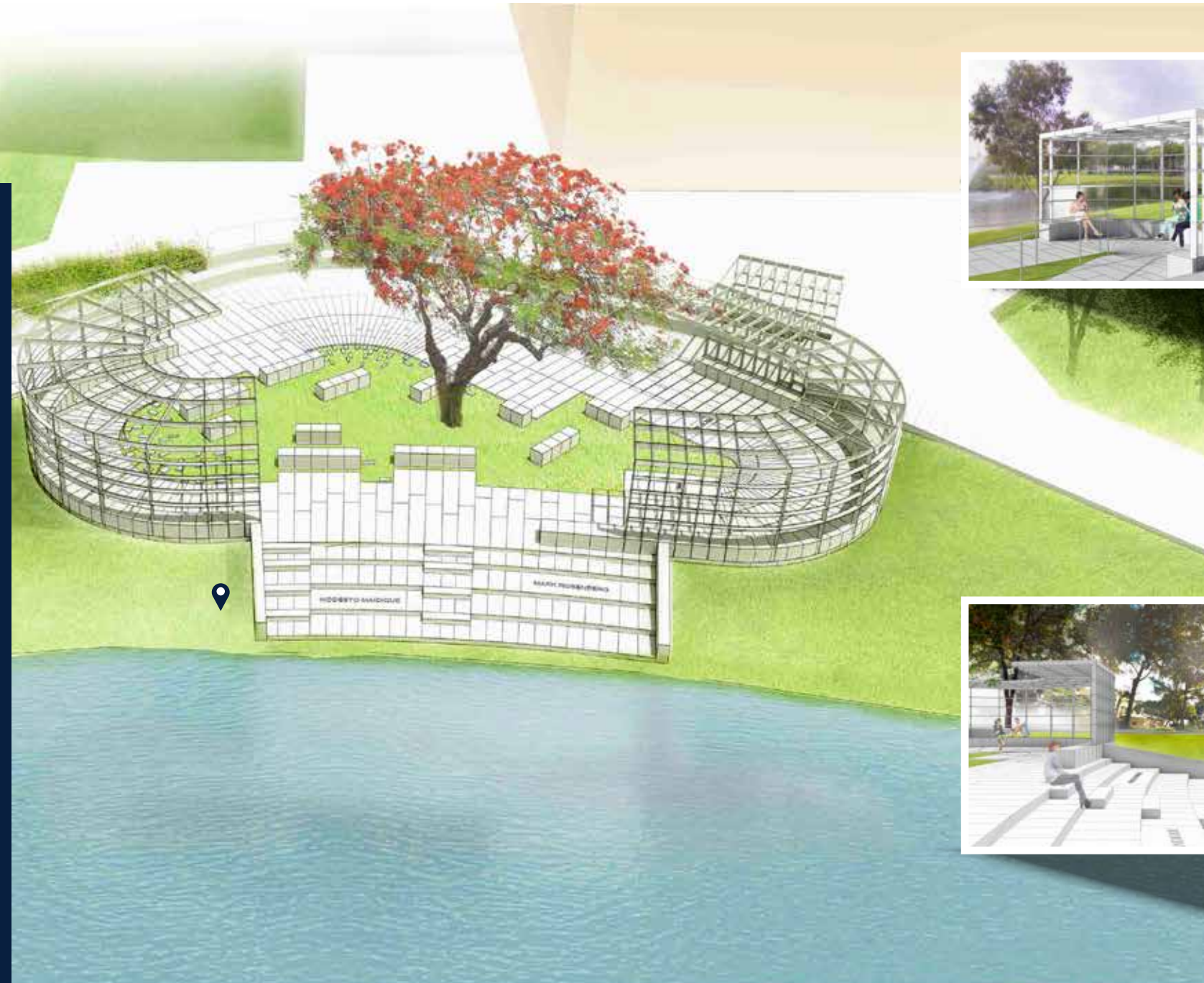

Lake amphitheater seating - View looking south from lake amphitheater seating with south trellis in view

Entry trellis pavilion - View looking northwest with SIPA building beyond, featuring custom pavers, rounded bench, and overhead shade structure



Lake amphitheater seating - View looking south from lake amphitheater seating with south trellis in view

How About a Tour?

📍 Historic Location

Nestled just west of Deuxieme Maison — one of the campus' first buildings, which earlier served as the main office for most of the institution's founding faculty — **FOUNDERS PARK** will be near the historic center of campus. This proposed site overlooks a radiant body of water between Deuxieme Maison and the university's earliest building, the Airport Control Tower.

📍 Linking Past, Present, and Future

FOUNDERS PARK will be a cozy plaza that serves several purposes. It will memorialize the faculty and professional staff who inaugurated the university on September 14, 1972, with plaques throughout the location. In addition, passersby will utilize its comfortable benches and other seating for a quiet resting or contemplation place, as they take in the abundant fauna and restful view of the water. For others, it will serve as a place to linger in order to finish class assignments or connect with friends.